

## COLLECTION & PLAN CABINETS



### Features

- Fully welded construction from 1.1mm thick steel
- Standard sizes to fit A1, A0 and B1 paper
- Paper weights included in each drawer
- Full extension drawers
- 4 bearing wheels for each drawer for easy operation and longevity
- Aluminium extrusion handle with built-in ticket strip
- Kick Plate Height: 70mm
- Top Plate Height: 30mm
- Australian designed, engineered and manufactured

### Accessories (available separately)

- Plan Cabinet Stand
- Plan Cabinet Heavy Duty Stand
- Castor Kit

### Technical Specifications

<b>Heights</b>	470mm	<b>Castor Kit</b>	100mm Diameter urethane wheels 2 with breaks and 2 without brakes per cabinet
<b>Widths</b>	950mm – A1 1740mm – B1 1295mm – A0	<b>Plan Cabinets Stand</b>	Bolted together 1.5mm steel legs and 1.1mm steel supports To suit 1 plan cabinet only Heavy duty stand also available
<b>Depths</b>	650mm – A1 900mm – A0 and B1	<b>Colours</b>	Range of <a href="#">Dulux Powder Coat Colours</a> (some colours may attract surcharges)
<b>Configurations</b>	5 Drawers 10 Drawers		

NOTE: All dimensions are nominal and subject to change without notice. Contact CSM to discuss customisable sizes.

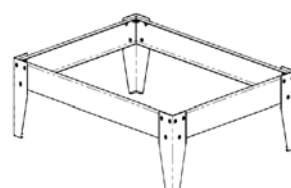
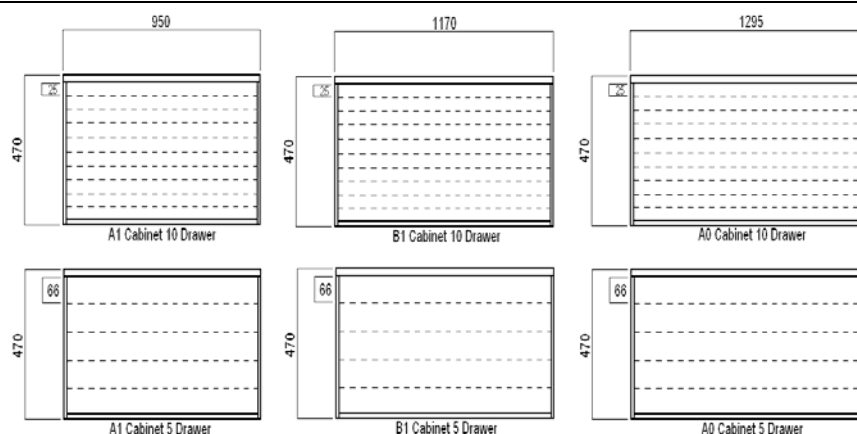

Plan Cabinet Stand

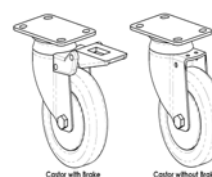

Castor Kit