

# CABINETS

RETRACTABLE, LOCKABLE, LATERAL

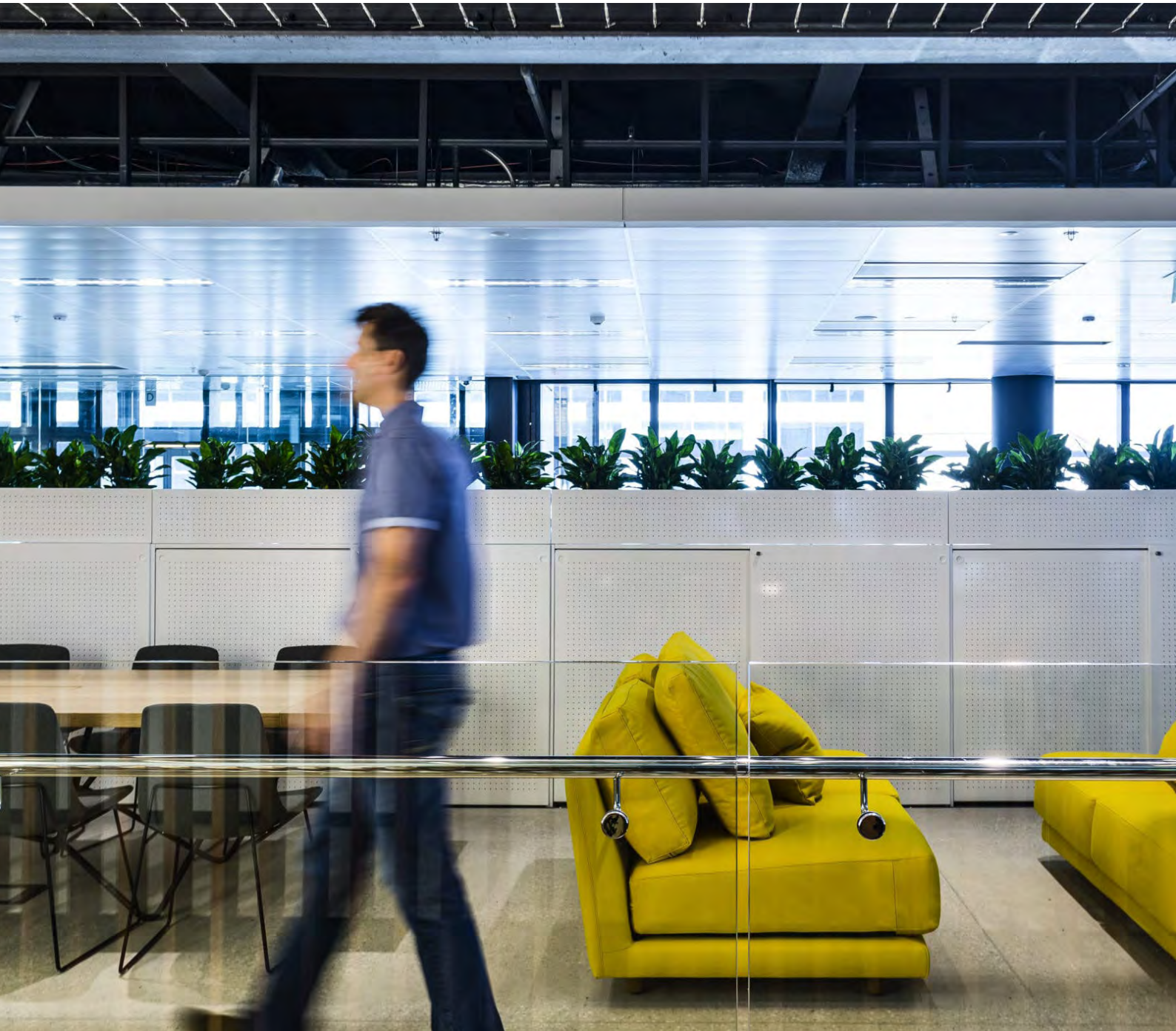

Architectural storage  
solutions for a changing world.  
Office Furniture Solutions

+61 2 9540 2111  
[sales@csm-office.com.au](mailto:sales@csm-office.com.au)  
[www.csm-office.com.au](http://www.csm-office.com.au)







## THE POWER OF STEEL

### CSM CABINET COLLECTION

Renowned for structural integrity, purposeful design and our company's commitment to a sustainable environment CSM designs superior products that co-exist for a better world.

At CSM, we understand the power of steel – the most-recycled material on earth. More steel is recycled every year than paper, glass, aluminium and plastic combined, meaning steel has the ability to leave a positive and long-lasting environmental impact. Our product stewardship commitment to zero-waste and non-toxic chemical use means that all CSM products are designed to be 100 per cent recycled. Everyday, we see the power of harnessing steel's recyclable potential to make real change. It gives us the backing to integrate each arm of our business to close the loop on waste.

Our cabinets and unique storage solutions are manufactured to your specifications in our Australian factory. With a diverse range of Australian-made lockers and storage solutions, there are no material or shipping delays.

For over 30 years we have been providing lockers and storage solutions for a diverse range of government departments, education and workplace environments.





## DIVERSE SOLUTIONS

### CSM CABINET COLLECTION

CSM manufacture Australia's largest range of commercial-grade storage cabinets, crafted with future-proofed design.

Our modular range includes endless options. From Retractable or Hinge door cabinets to Lateral and Flipper door units to the timeless Tambour cabinets, all CSM Cabinets are fully lockable, safeguarding valued items and documents.

With an extensive range of cabinets including open bookcases, recycling stations, touch-less recycling units and hide-away waste units. CSM's collection offer a hygienic and waste-conscious solution for progressive workplaces.

Accommodating various uses along with Galleries and Museums, CSM's Plan cabinets are crafted to house plans and precious documents of varying sizes. The Collection Cabinets range are suited to store delicate artwork and fragile materials whilst our media cabinets are available in a choice of horizontal or vertical. If highest security is a key consideration factor, our range includes B & C Class Cabinets or specialty Taser Cabinet for specifically designed for the law enforcement.

All cabinets come in a variety of sizes to increase the amount of functional storage space.







# SUSTAINABILITY

MADE TO LAST A LIFETIME

At CSM, we understand the power of steel – the most-recycled material on earth. More steel is recycled every year than paper, glass, aluminium and plastic combined, meaning steel has the ability to leave a positive and long-lasting environmental impact. Our product stewardship commitment to zero-waste and non-toxic chemical use means that all CSM products are designed to be 100 per cent recycled. Everyday, we see the power of harnessing steel’s recyclable potential to make real change. It gives us the backing to integrate each arm of our business to close the loop on waste.

The sustainable management of all on-site production, freighting and installation processes underpin CSM’s successful performance in frequent environmental audits.

As part of CSM’s corporate social responsibility commitments, we champion local talent, working with Indigenous artists and community workshops. CSM and its suppliers proudly employ the following standards with integrity across arms of business:

- Recycle materials on site
- Employ energy saving lighting
- Water is not used in production processes and any waste water is recycled
- Operating under a zero-emission policy
- Exclude all harmful chemicals from the production process
- Remove all packaging from site for recycling

Most importantly our commitment to high quality materials ensures our products are robust and made to last a lifetime.



CSM’s lead-by-example approach has been awarded with GECA’s Good Environmental Choice Label and Ecospecifier endorsement for the supply of eco-preferable products in Australia, Asia-Pacific and the Middle East. CSM products carry accreditation under the ISO 14000 series.

CSM is also a member of the Green Building Council of Australia – part of the World Green Building Council – and has proudly participated in Australia’s highest green star rated commercial fit-outs, supplying green rated storage systems.





Tambour Door Cabinets + Planter



Flipper Door Cabinet

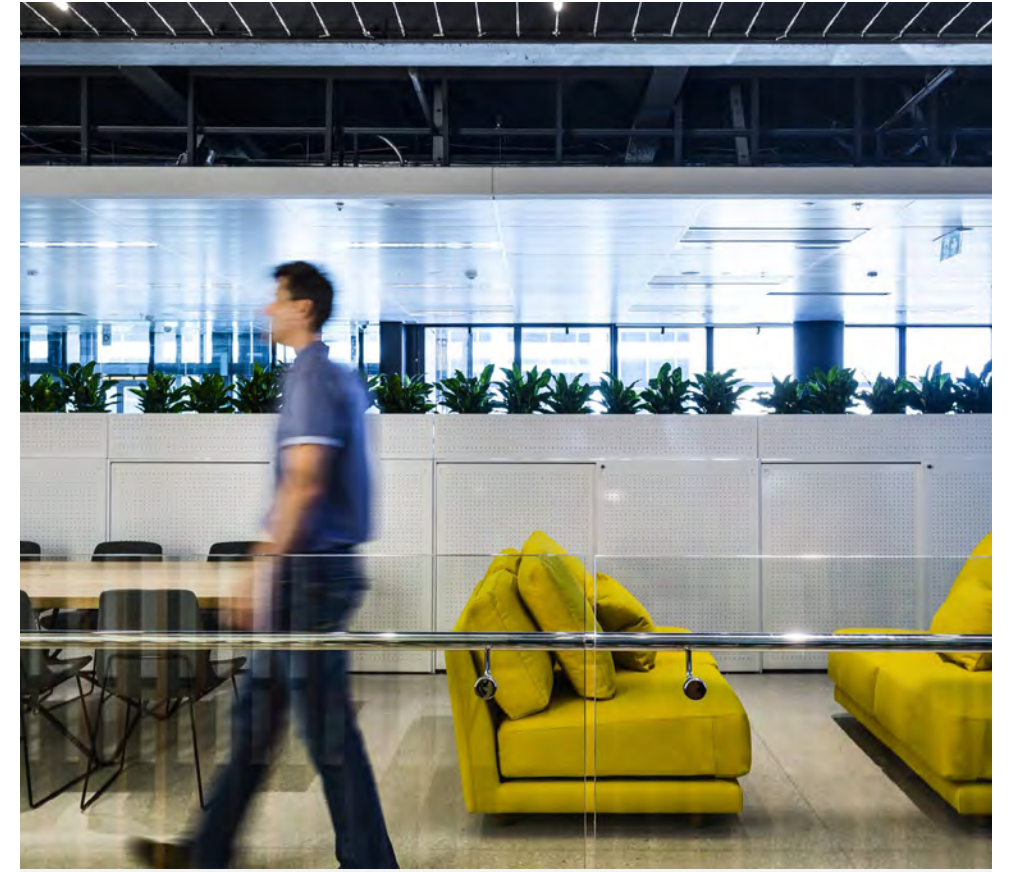

Evolution Sliding Door



Tambour Door Cabinets + Planter



Infinity Retractable + Planter



Work Aisles Cabinet Collection





Work Aisle Duo + Planter, Lockers and Bookcase



Infinity Tambour Door Cabinet



Plan and Collection Cabinets



Work Aisles Duo Elevated Leg, Hinge Door Cabinets



Infinity Hinge Door Cabinets



# WORK AISLES

SIMPLE AS UNO, DUO, TRIO



Work Aisles smart storage space divider range features lockable shared storage in either single, double or triple units – also known as Uno, Duo, Trio.

Open, closed, locked or touch free – you can easily adapt the Work Aisle modules to mix lockers, hinged door cabinets, bookcases, touch-free rubbish and recycling cabinets in a variety of sequences to meet the storage needs of each work zone. Designed for flexibility Work Aisles are perfect for seamless side-by-side banking and space management.

## Product Features

- Hinged door cabinets with adjustable shelves
- Add open bookcases to display and organise books and stationery
- Provide teams with hygienic touch-free rubbish and recycling cabinets
- Locking flexibility
- 200+ powder coat finishes, UV-resistant colours that won't fade or chip
- Select from durable custom laminate bench top finishes
- High quality 0.95mm zinc seal steel powder coat finish
- Modular and reconfigurable design
- Effortless maintenance
- Easy disassembly, reusable and fully up-scalable, recyclable.
- Australian designed and engineered
- NSW Government & Education Contract Approved
- Highest Green Star Rating: FSC and GECA FFMv3.0-2017 Level A
- ISO Certified: ISO 9001 Quality Assurance and ISO 14001 Environmental Management System

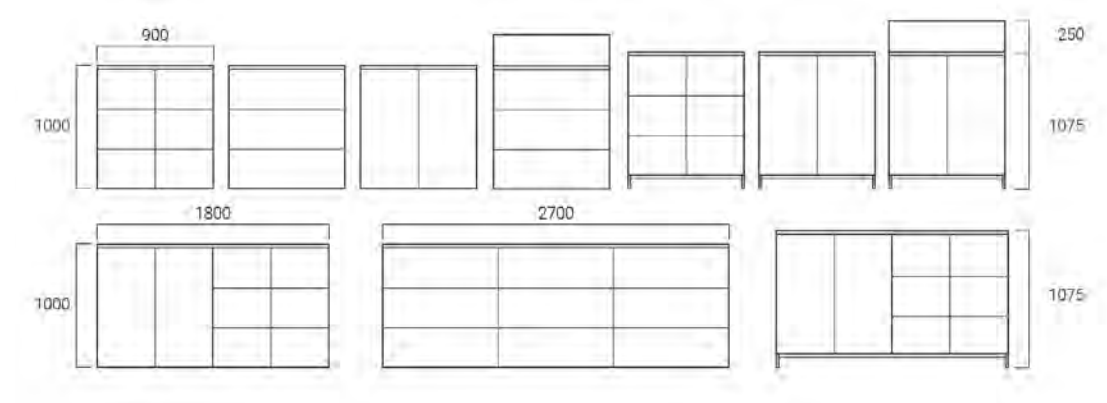
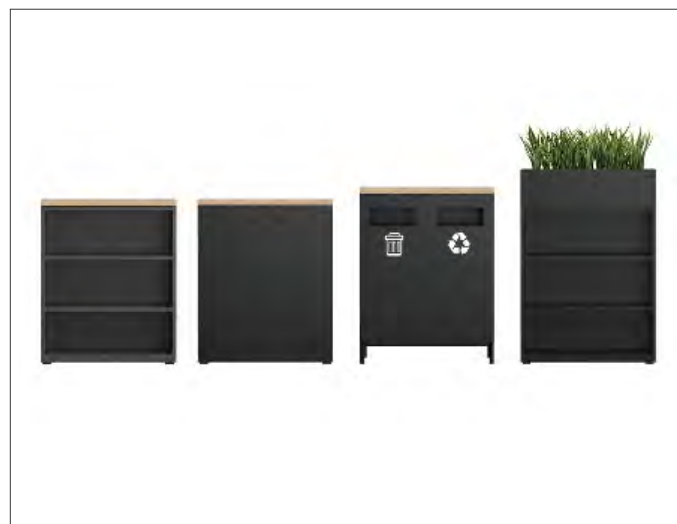

[VIEW TECHNICAL SPECIFICATIONS](#)





CSM Cabinet Collections are all Australian designed and manufactured, which means shorter lead times greater flexibility and sustainability.



# INFINITY CABINETS

## TAMBOUR AND RETRACTABLE DOOR



The CSM Infinity Cabinet collection offers stylish aesthetics combined with a high level of flexibility. This results in a wide selection of filing and storage options.

CSM's Infinity range includes endless options. From Retractable or Hinge door cabinets to Lateral door units to the ever popular Tambour cabinets, all fully lockable, safeguarding valued items and documents. When items need to be displayed the Infinity open bookcases are an ideal. Require something more practical, the Infinity 2, 3 and 4 drawer filing cabinet are ideally suited to any environment. All cabinets come in a variety of sizes to increase the amount of functional storage space. Infinity offers no door protrusion when open, which is excellent for occupational health and safety in the workplace. The Tambour Door Cabinet is also fitted with the CSM easy slide door mechanism. Couple with Infinity Planter Boxes specifically designed to fit the Infinity Cabinet Range.

### Product Features

- Only the CSM Tambour Door Cabinets offer no protrusion when open
- Ideal for corridor areas – no door protrusion
- CSM easy slide door mechanism, ensures trouble free and easy operation
- Australian designed, engineered, manufactured, fully welded steel construction
- Range of colour choice for PVC door or Aluminium Slat
- Adjustable levelling feet to ensure line is maintained where cabinets are side by side and for uneven floors
- Single point locking system
- Removable lock barrel
- Coat compartment configuration available
- NSW Government & Education Contract Approved
- Highest Green Star Rating: FSC and GECA FFMv3.0-2017 Level A
- ISO Certified: ISO 9001 Quality Assurance and ISO 14001 Environmental Management System

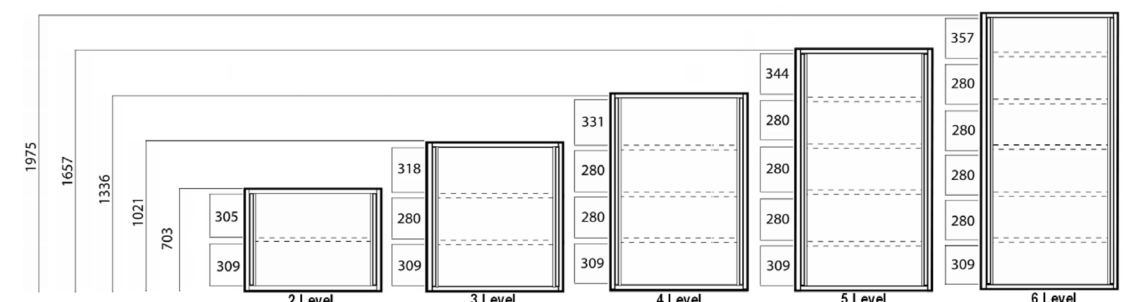

[VIEW TECHNICAL SPECIFICATIONS](#)



# PLAN & COLLECTION CABINETS

HORIZONTAL AND VERTICAL PLAN CABINETS



CSM range of Plan and Collection Cabinets include horizontal and vertical plan cabinets to cater for the storage of a variety of paper sizes. CSM provides versatility in storing your collections and fragile material. Cabinets are available as free-standing units or customise your specialty cabinet with a Stand or Castor Kits for ease of movement.

## Product Features

- Ideal for housing a storing your collections or plan.
- Constructed from fully welded steel for longevity
- Standard sizes to fit A1, A0 and B1 paper
- Paper weights included in each drawer
- Full extension drawers
- 4 bearing wheels for each drawer for easy operation
- Aluminium extrusion handle with built-in ticket strip
- Australian designed, engineered and manufactured
- NSW Government & Education Contract Approved
- Highest Green Star Rating: FSC and GECA FFMv3.0-2017 Level A
- ISO Certified: ISO 9001 Quality Assurance and ISO 14001 Environmental Management System

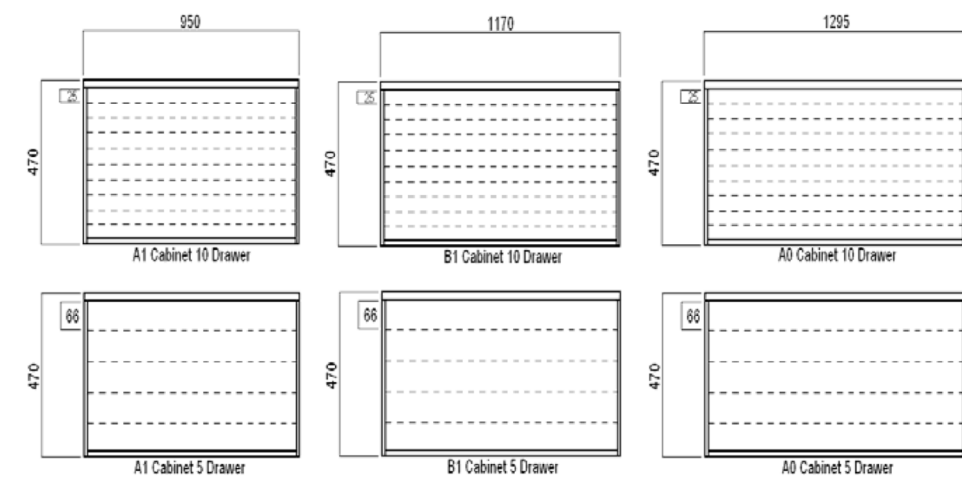

[VIEW TECHNICAL SPECIFICATIONS](#)



# EVOLUTION SLIDING DOOR

CHANGE AND EVOLVE



Evolution sliding door cabinet is a functional yet stylish solution with its continuous, symmetrical lines. Featuring CSM's unique perforation pattern, our elegant Evolution Planter Boxes sit neatly on top of the units without interfering with locking mechanisms. Evolution is available with timber or laminated tops and end panels various colour options, acoustic or fabric inserts.

Evolution is also available in single or dual sided configurations. This allows for efficient access, minimising space consumption and can create a screen within the office environment.

## Product Features

- Fully internal welded construction for durability
- Locks are fitted to all cabinets as standard
- Single locking door (keyed alike or keyed to differ)
- Option available for dual sided configurations, minimising space
- Doors and panels installed onsite
- Cabinet top finishes flush/level with the front door, sides and back
- End panels, top panel and shelves can be powder coated in different colours to the body assembly for added appeal
- Australian designed, engineered and manufactured

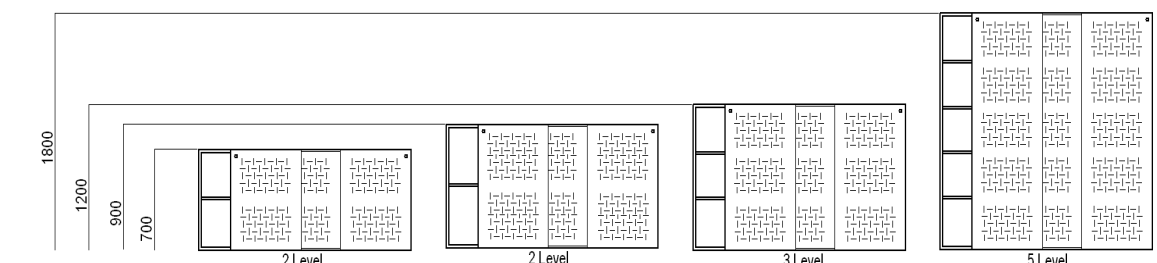

[VIEW TECHNICAL SPECIFICATIONS](#)



# FLIPPER CABINETS

## FLIPPER RETRACTABLE DOOR



The Flipper Door Cabinet range is an elegant, high capacity storage range, which has been incorporated into CSM's expansive collection of Australian designed and manufactured office storage solutions. Flipper Door Cabinets are able to be customised with choice of colour, door perforations as well as the addition of CSM Flipper Door Planter Boxes to match. Each door opens individually enabling secure but flexible file access.

Added Security Flipper Door range offers high security with two point locking on every door and all doors fully retract to give the impression of an open face book shelf. Also available as a single locking door for individual usage. Flipper Door range offers two options of door heights for lateral or lever arch filing.

### Product Features

- Ideal for Lateral or Lever Arch Filing
- Fully internal welded construction for durability
- Each door opens individually enabling secure yet flexible file access
- All doors fully retract for easy access
- Two point locking on every door
- Also available as a single locking door for individual usage
- Australian designed, engineered and manufacture
- NSW Government & Education Contract Approved
- Highest Green Star Rating: FSC and GECA FFMv3.0-2017 Level A
- ISO Certified: ISO 9001 Quality Assurance and ISO 14001 Environmental Management System

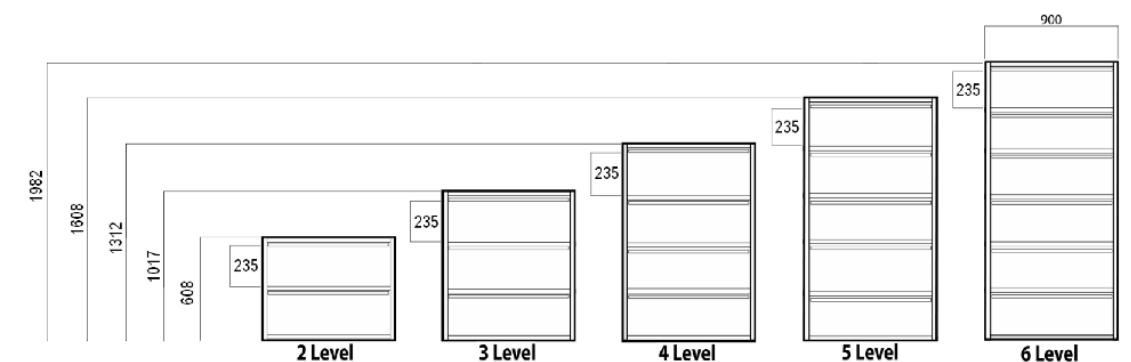

[VIEW TECHNICAL SPECIFICATIONS](#)



# SECURITY CABINETS

CLASS B & C SECURITY AND TASER CABINETS



When security is the key consideration factor CSM manufactured SCEC endorsed security cabinets and mobile shelving solutions are ideal. Safeguard features engineered into each unit include – additional strength in the steel, increased welding and SCEC approved special locking mechanisms provide the highest security together with aesthetics for all security environments. Select from B or C Class rating dependent on application.

The CSM Range includes both B & C Class and Security Cabinets and B & C Class Rolling Storage (for high density applications) options. CSM has also been a long been a trusted supplier for manufacturing specialty Taser Cabinets for the Law Enforcement Sector.

## Product Features

- Recommended for all floor surfaces regardless of variable levels
- Base sits on floor – no cutting in to carpet required
- Welded pre-fabricated, low profile base with adjustable levelling jacks for uneven floors
- Fully modular in design, units can be relocated
- 3 Point – Bi-Lock Locking System
- Ventilation Holes in Doors and Back
- Advanced levels of security with SCEC endorsed B and C Class locking systems
- Australian designed, engineered and manufactured
- NSW Government & Education Contract Approved
- Highest Green Star Rating: FSC and GECA FFMv3.0-2017 Level A
- ISO Certified: ISO 9001 Quality Assurance and ISO 14001 Environmental Management System



[VIEW TECHNICAL SPECIFICATIONS](#)



# OUR STORY

## ABOUT CSM

65 years of experience means that CSM is a brand that Australia trusts. We take pride in our long term relationships and work with the country's leading corporate and professional services, government bodies, education providers and cultural organisations – designing products to support innovative Australians and delivering storage solutions engineered to perform today and well into the future.

We started as a design focused business in the 1950s, and we continue to honour the ethos with a commitment to Australia's manufacturing sector – becoming a leading manufacturer of corporate, institutional, campus and conservation storage solutions. We pioneered computer controlled machinery in the 70s and remain at the forefront of Australia's fully automated fabrication facilities.

As a proudly Australian-made, owned and operated company, CSM recognises the value of concentrating operations at a local level.

Recognised for our work in steel, we have become Australia's go-to leading specialists in workplace storage design, engineering and manufacturing solutions tailored to specific design outcomes and budgets, delivered nationally under competitive lead times.

By keeping our design, engineering and manufacture capabilities under one roof, CSM's vertically integrated business model allows for:

- Reduced lead times
- Rapid prototyping capacity
- Exhaustive custom offering
- New product development built to client specification



“Over the past 65 years, we’ve built trust with government and corporate clients along with a demonstrated ability to deliver large scale projects within the property industry. We are contract suppliers for the government with 25+ years of successful delivery for the education and public sectors.

Renowned for our work with high quality steel, we are proud to be Australia's specialised Architectural Storage Solutions provider utilising the power of steel – the most-recycled material on earth and leaving a positive and long lasting environmental impact.

Our success has been underpinned by our commitment to continuous improvement through innovation and technology.”

– Mark Durrington & Peter Letton, Co Managing Directors





CSM-OFFICE.COM.AU

